

# CBD ALCOHOL FREE ZONE

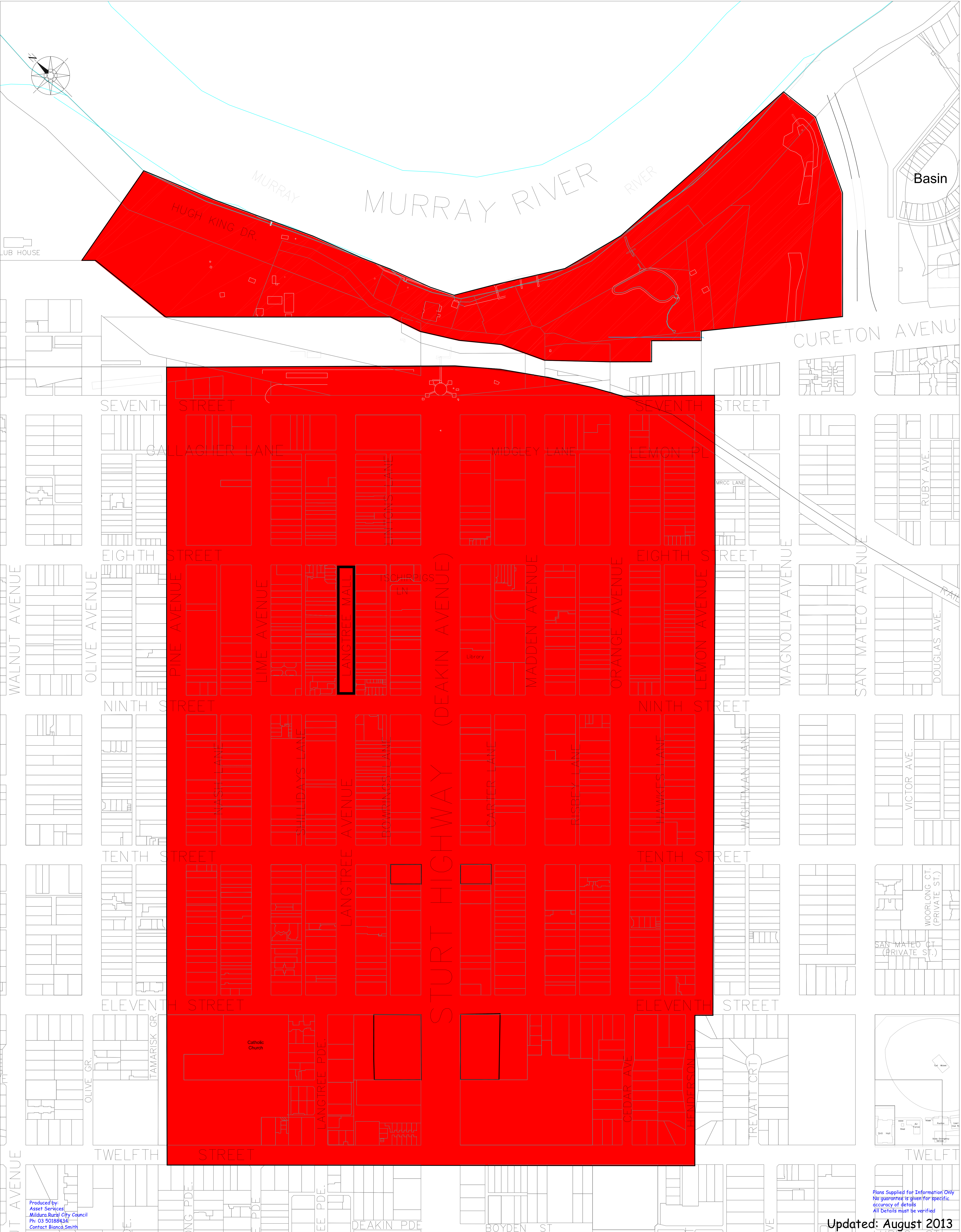

Produced by:  
Asset Services  
Mildura Rural City Council  
Ph: 03 50188434  
Contact Bianca Smith

Plans Supplied for Information Only  
No guarantee is given for specific  
accuracy of details  
All Details must be verified

Updated: August 2013

 Area within which consumption of liquor is prohibited pursuant to L7.1

# MILDURA BUXTON PARK

Scale 1:2000

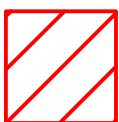
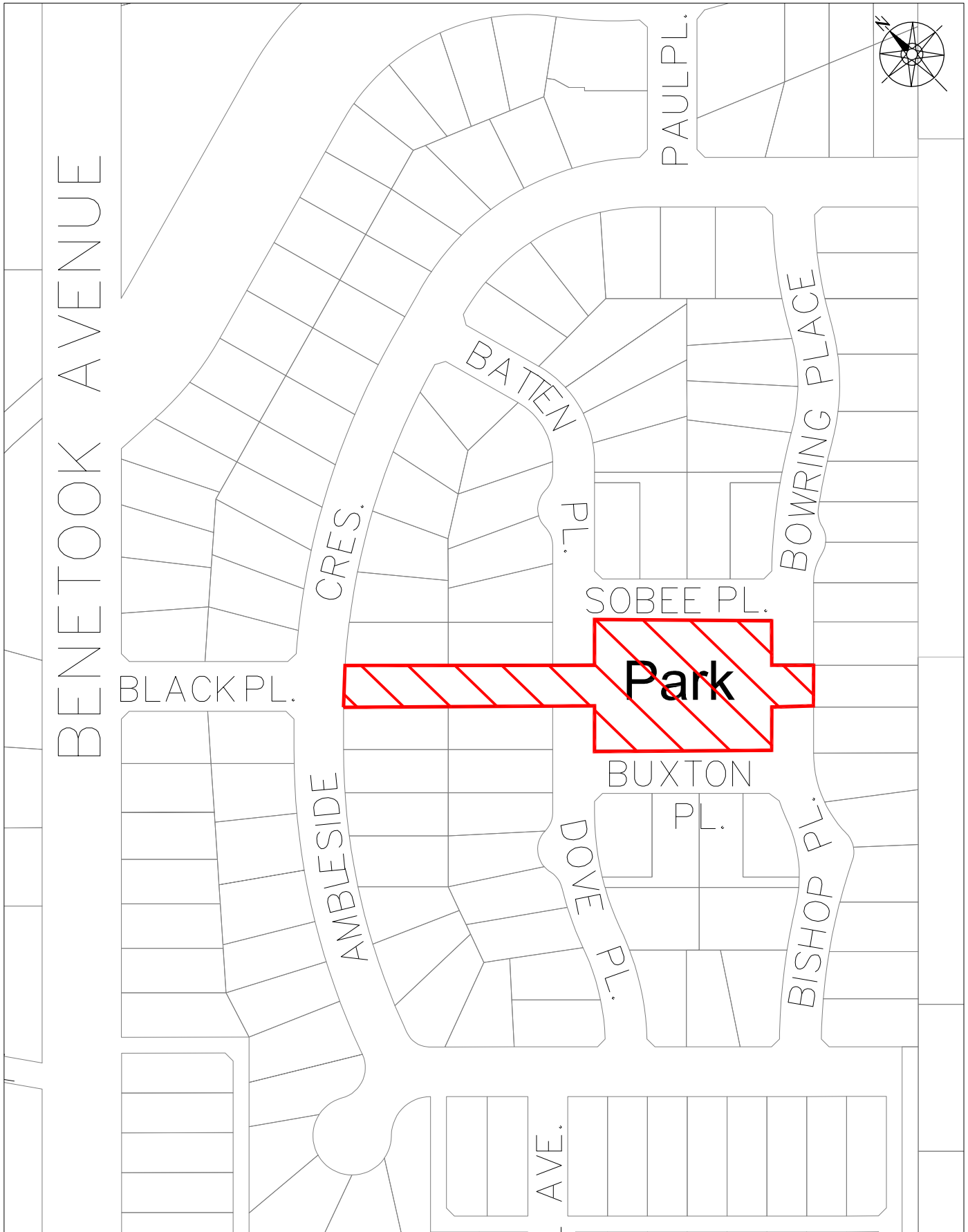

Area within which consumption of liquor is prohibited pursuant to L7.1

# MILDURA GREEN PINES PARK

Scale 1:3000

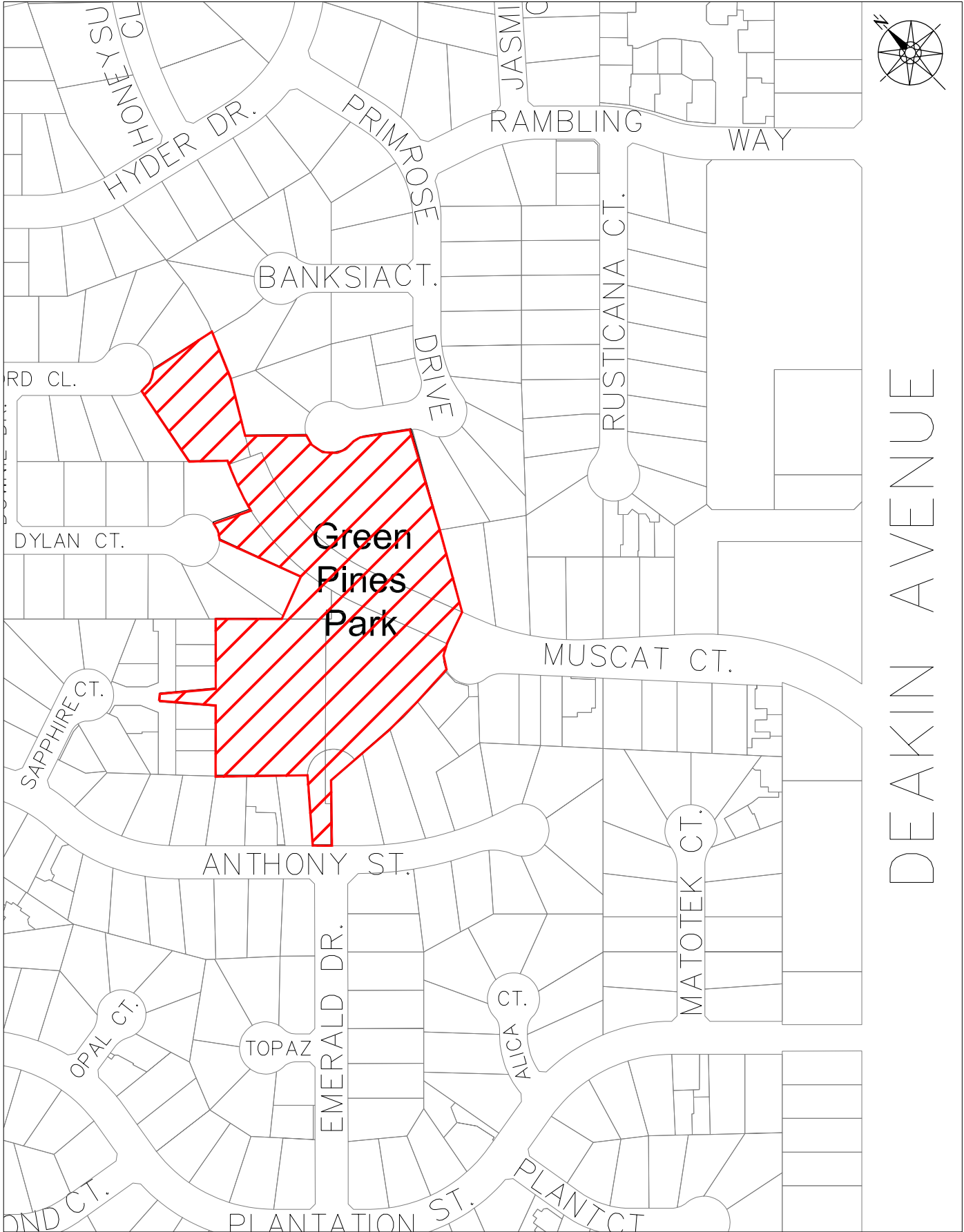

Area within which consumption of liquor is prohibited pursuant to L7.1

# MILDURA HENDERSON PARK

Scale 1:1000

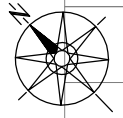

Area within which consumption of liquor is prohibited pursuant to L7.1

# IRYMPLE TOWNSHIP

Scale 1:1000

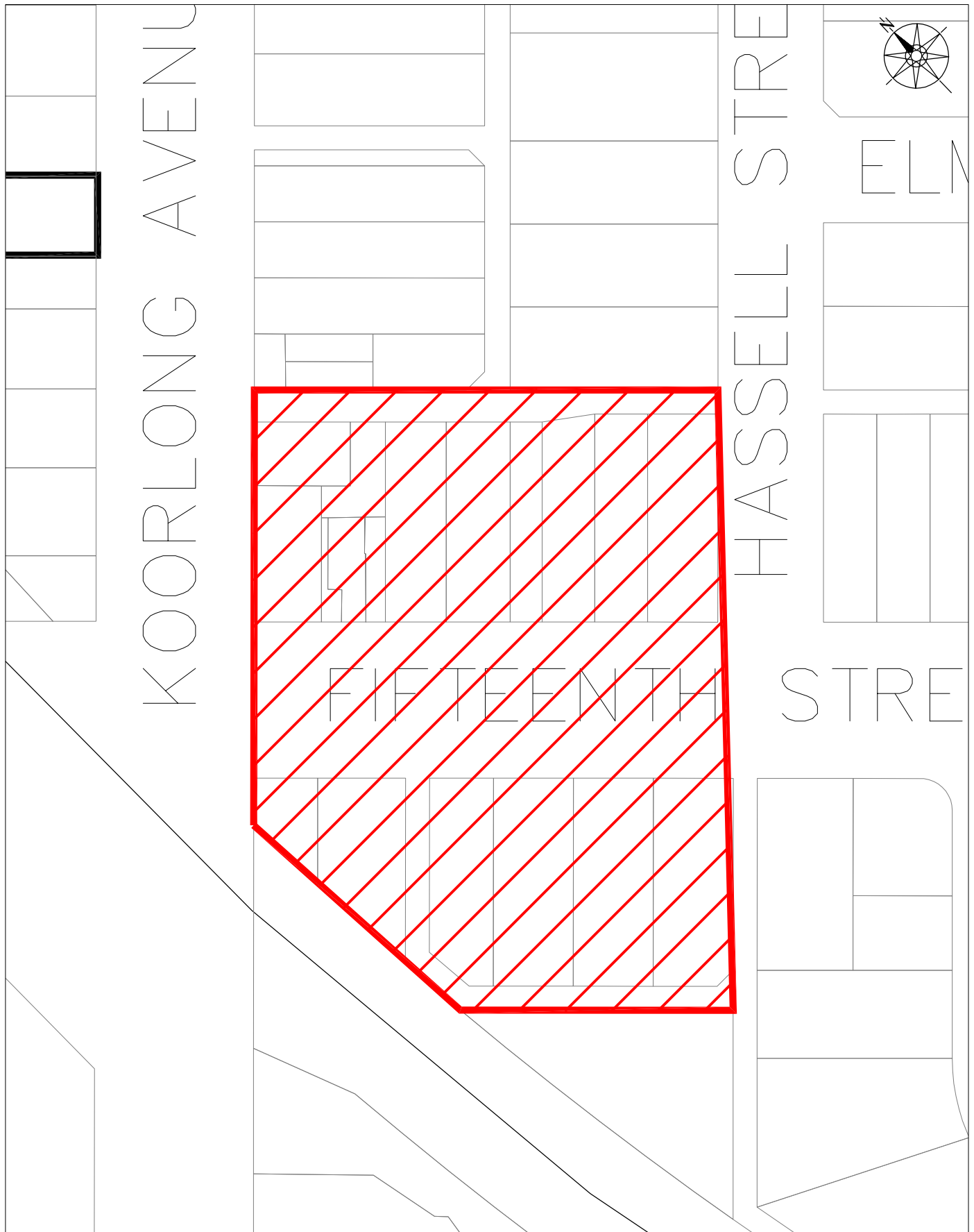

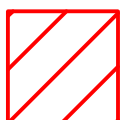
 Area within which consumption of liquor is prohibited pursuant to L7.1

# MERBEIN TOWNSHIP

Scale 1:3000

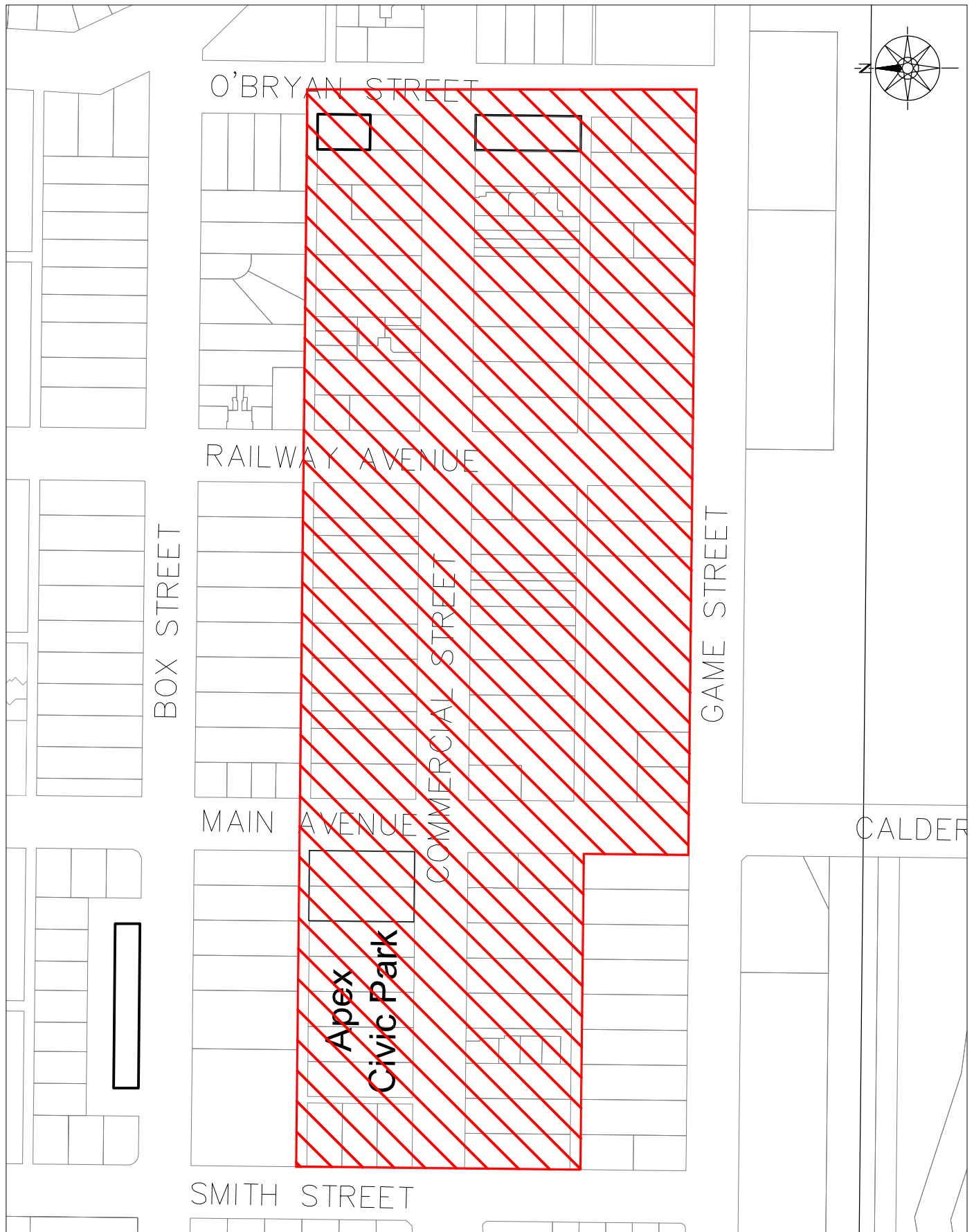

 Area within which consumption of liquor is prohibited pursuant to L7.1

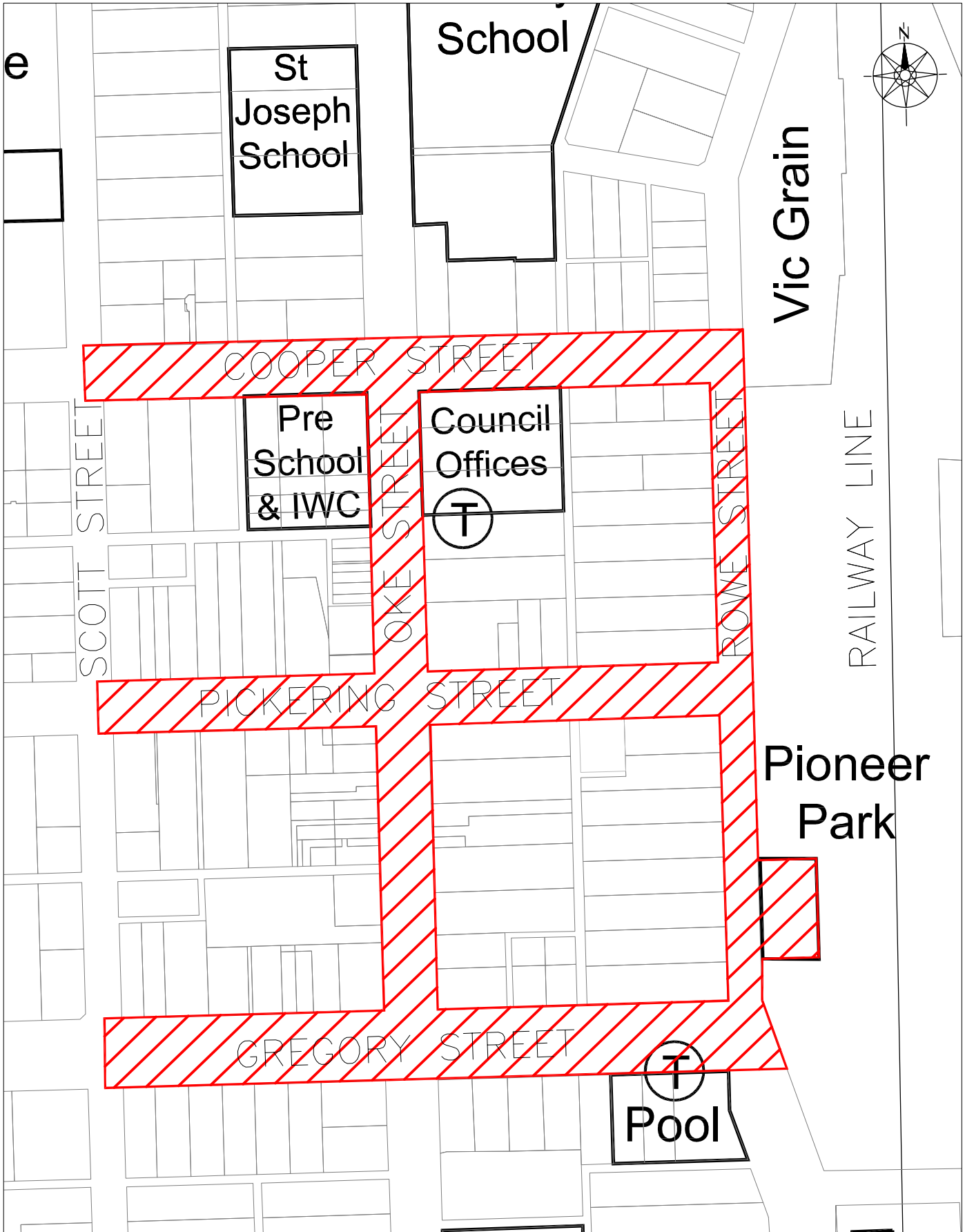

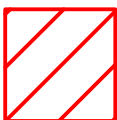
 Area within which consumption of liquor is prohibited pursuant to L7.1

# RED CLIFFS TOWNSHIP

Scale 1:3000

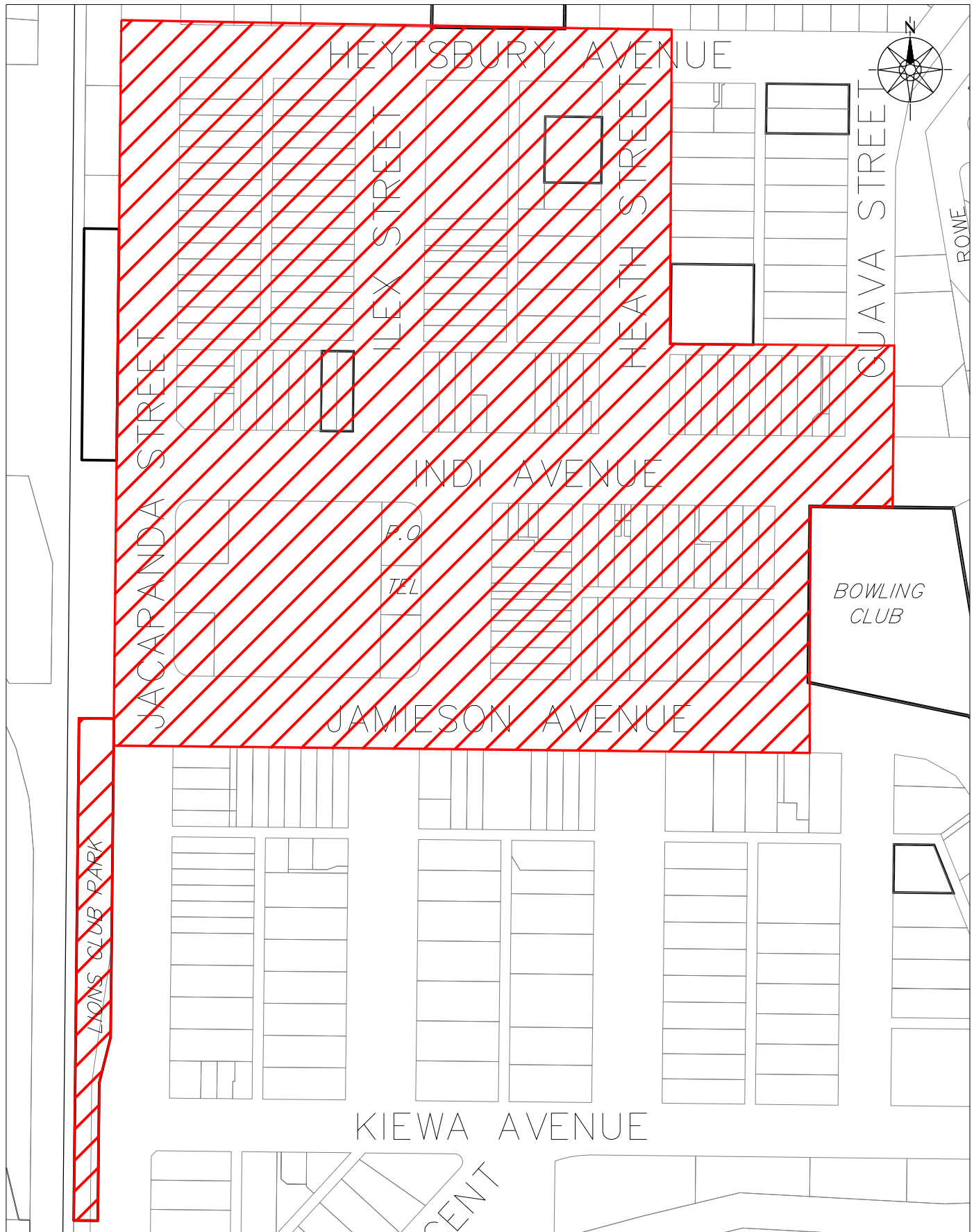

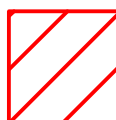
 Area within which consumption of liquor is prohibited pursuant to L7.1