

*Connell Wagner Pty Ltd
ABN 54 005 139 873
60 Albert Road
South Melbourne
Victoria 3205 Australia*

*Telephone: +61 3 9697 8333
Facsimile: +61 3 9697 8444
Email: cwmel@conwag.com
www.conwag.com*

Residential Development Plan Red Cliffs

*Prepared for
Mildura Rural City Council*

*November 2002
Reference: Report04_Red Cliffs (Final)*

Table of Contents

Section	Page
1. Introduction	1
2. Project Work Program	2
3. Development Plans	4
3.1 Purpose of the Development Plans	4
3.2 Design and Development Principles	4
4. "Red Cliffs"	6
4.1 Description of Site and Surrounds	6
4.2 Town Planning	6
4.3 Infrastructure and Servicing	6
4.4 Landscape	7
4.5 Traffic	7
4.6 Strategic Context Plan	7
4.7 Red Cliffs Development Plans	7
5. Implementation	10
5.1 Staging	10
5.2 Ownership	10
5.3 Development Contribution Plan	10
5.4 Future Planning Scheme Review	11
5.5 Approval processes	11
6. Draft Development Plan Schedules	12
 Appendix A	
Aerial Photograph	
 Appendix B	
Strategic Context Plan	
 Appendix C	
Development Plan	

1. Introduction

Mildura Rural City Council is committed to facilitating proper and orderly development of future residential areas through the Mildura Planning Scheme.

To assist in achieving this objective Council have commissioned Connell Wagner to prepare development plans for six (6) designated future residential areas in Mildura, Irymple and Red Cliffs.

For the purposes of this project, these areas are known as:

1. Mildura South;
2. East of the Grange;
3. Stage 3 Residential;
4. North Irymple;
5. South Irymple; and
6. Red Cliffs.

The location of these development plan areas is depicted below.

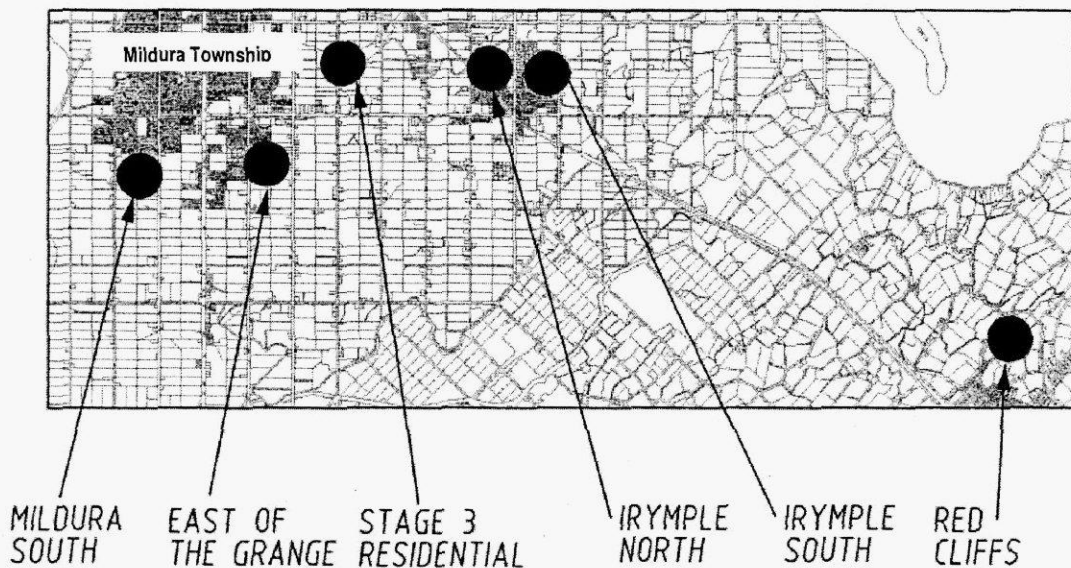

Figure 1 - Locality Plan
Not to Scale
Source: State Map Base

Each future residential development area is strategically located within designated growth corridors and in most cases is already zoned Residential 1 with a Development Plan Overlay applying to the land.

Within the Mildura Planning Scheme, the provisions of the Development Plan Overlay prevent a Responsible Authority (ie. Council) from granting planning approval for subdivision and residential development in the absence of an overall development plan.

Presented within this report is a development plan to co-ordinate the proper and orderly development of land. Also presented within is an account of key matters considered during the preparation of these plans and an implementation program (including a draft schedule to the Development Plan Overlay)

2. Project Work Program

A thorough Work Program has been followed during the course of this project.

Detailed below is a brief account of each of the seven (7) stages undertaken to inform the project and to prepare the development plans and this supporting report.

Stage 1- Site Review and Research

A detailed inspection of each development area was undertaken, contemporary aerial photography purchased and relevant documentation reviewed. A valuable appreciation of each development area was provided through this work and has been incorporated into the project as appropriate.

Stage 2- Stakeholder Consultation

Discussions were conducted with a wide range of stakeholders. These included:

- Department of Education, Employment and Training
- Lower Murray Water
- Origin Energy
- First Mildura Irrigation Trust
- Telstra
- Wentworth Shire Council
- Sunraysia Rural Water Commission
- Powercorp
- Mallee Catchment Management Authority

Several departments of the Mildura Rural City Council were also consulted. These included:

- Town Planning
- Engineering
- Aged and Disability Services
- Family Services

Stage 3 - Issues Paper

An assessment of town planning (statutory and strategic), engineering (infrastructure and servicing), landscape (vegetation and urban design), and traffic engineering (roads and vehicle generation) was undertaken to inform the design of the development plans and to incorporate a multi-discipline approach to preparation of the development plans. The findings of each of these assessments was presented in the form of an Issues Paper.

A summary of key issues is presented in Sections 4 of this report.

Stage 4 - Community and Development Industry Workshops

A series of Community and Development Industry Workshops were conducted on the 6th and 7th of June 2002. These workshops provided a valuable opportunity to inform land owner and development industry representatives of the project and to discuss the development intentions of landowners and potential design considerations.

To stimulate discussion regarding the future development opportunities, a number of development plans were presented at this time with the view to refining these with Council.

It is noted that during the Community and Development Industry Workshops, a very strong position was stated by a large majority of those in attendance that the plans should not be overly prescriptive in terms of directing future subdivision design or potentially stifling potential market badging of different residential areas. Careful consideration has been given to this matter during the preparation of the draft development plans.

Stage 5 - Draft Development Plans

A draft development plan for each development area was prepared utilising information gathered during the course of the project.

This plan represents an environmentally sensitive approach to residential development which seeks to reduce the reliance on upgraded stormwater infrastructure. Best practice stormwater water management identifies the potential for stormwater to be utilised for the purposes of natural wetland systems or temporary and permanent water bodies. In turn, these features may contribute a unique and attractive feature when coupled with open space networks and bicycle paths.

Stage 6 - Supporting Report

To support the presentation of the draft development plan, a supporting report has been prepared. This report provides an explanation of the project, presents the development plan and presents a draft implementation program through the Mildura Planning Scheme.

Stage 7 - Exhibition of Plans

The development plan will be placed on public exhibition and comments invited from interested stakeholders.

Stage 8 - Determine Preferred Development Plan

After considering written comments received during the public exhibition process, a plan will be adopted by Council (with or without amendments).

Stage 9 - Council Approval and Implementation

The preferred plan will be formally endorsed and approved by Council. Appropriate measures will be undertaken to commence implementation through the Mildura Planning Scheme.

Any submissions to be considered prior to Council approval of the preferred development plan must be forwarded to :

James Golsworthy
Planning Manager
Mildura Rural City Council
P O Box 105
MILDURA 3502

3. Development Plans

3.1 Purpose of the Development Plans

The purpose of a development plan is to guide and facilitate residential development to achieve the proper and orderly development of land.

3.2 Design and Development Principles

To guide the preparation of the development plans a suite of design and development principles has been compiled to achieve development outcomes responsive to the Mildura, Irymple and Red Cliffs situation.

These principles include, but are not limited to:

Principal 1 - Land Development

Principle 1.1 – Range of Lots Sizes

- Ability to subdivide land to a range of conventional urban lot sizes.

Principle 1.2 – Potential Land Use Conflict

- Recognise the relationship between potentially conflicting land uses including:
 - Adjoining business and industrial areas.
 - Designated highways and high volume roads.
 - Railway reservations.
 - Potentially noisy service infrastructure (ie. irrigation water pumps)

Principle 1.3 – Integration with Surrounds

- Encourage the protection and continuation of recognised features of the development area and surrounds including:
 - Recognised and listed heritage properties
 - Existing drainage lines and topographical character.
 - Existing infrastructure and services.
 - Existing dwellings and properties identified through consultation.

Principal 2 - Road Network

Principal 2.1 – Safety and Efficiency

- Promote a safe and efficient local road network that eliminates short-cuts through residential areas.

Principal 2.2 – Integration with Surrounds

- Creation of a collector and local street network to compliment the surrounding roads.

Principal 2.3 – Integration with Surrounds

- Extension of local streets networks through adjacent areas (where appropriate).

Principal 2.4 – Access to Major Roads

- Minimise and restrict the number of street access points to the surrounding road network.

Principle 3 - Infrastructure Provision / Retirement

Principle 3.1 – Best practice services

- Promote best practice and environmentally sensitive solutions to the provision infrastructure and services to the satisfaction of the relevant service authorities and Mildura Rural City Council.

Principle 3.2 – Co-location of Drainage Reserves and Open Space

- Encourage the provision of a drainage reserve / open space network designed to:
 - Compliment the existing and proposed drainage infrastructure.
 - Contribute a usable open space network for active and passive recreational activities.
 - Contribute a marketable and visually attractive feature to the development area.
 - Promote centralised access to open space within the development area.

Principle 3.3 – Infrastructure Retirement / Relocation

- Retire or relocate water supply or drainage infrastructure to the satisfaction of the relevant service authority.

Principle 4 – Staging of Development

Principle 4.1 – Co-ordination of Drainage Infrastructure

- Facilitate development in such a manner that is consistent with the provision of drainage infrastructure to the wider region.

Principle 4.2 – Cost Effective and Timely Development

- Stage development in such a manner to accommodate cost effective and timely development of infrastructure for development areas.

Principle 4.3 – Co-ordination Between Landowners

- Facilitate development of individual allotments with minimal reliance on adjoining landowners to provide access.

The purpose of the development plans is to “guide and facilitate” future residential development. These plans do not exclude the need for detailed features survey, subdivision plans and engineering design to be undertaken for each development area. Flexibility should be retained in the planning controls to enable the detailed subdivision plans to be modified from Council's adopted (preferred) development plan provided the modified plan is “generally in accordance” with Council's adopted plan and the intent and provisions of the design and development principles are not compromised.

4. “Red Cliffs”

Key characteristics of the Red Cliffs area and considerations acknowledged during the preparation of development plans are detailed below.

4.1 Description of Site and Surrounds

- The Red Cliffs development area has an area of approximately 60 hectares.
- The land is irregular in shape.
- This area is intensely used for grape growing.
- Only a few dwellings exist in this location.
- A village style residential area is surrounded by the development area.
- Presented in **Appendix A** is an aerial photograph of the development area.

4.2 Town Planning

4.2.1 Statutory Control

- This area is zoned Residential 1.
- A Development Plan Overlay applies to the entire precinct.
- There are no heritage listed items within the precinct. However there are some listed properties surrounding the precinct. These being Diggerland Theatre (HO111; and Big Lizzie (HO104), The Old Red Cliffs Urban Pump (HO167) the Red Cliffs Pumping Station (HO160/166) and Barclay Square (HO303).

4.2.2 Strategic Considerations

- The Mildura Municipal Strategic Statement identifies Red Cliffs as being a significant concentration of population outside Mildura.
- The Mildura Town Structure Plan identifies Red Cliffs as having a Stage 2 future residential opportunity. The precinct is on the boundary of urban growth.

4.3 Infrastructure and Servicing

4.3.1 Stormwater Drainage

- The Red Cliffs development area comprises a small catchment bounded on the north by residential development. The site generally grades to the north-east away from the township.
- Runoff from this development is likely to be directed to the existing stormwater drainage system. Following the capacity review of the existing system, it is likely that on-site detention will be required to reduce outfall rates under peak events.
- The Sunraysia Drainage Strategy recommends that new urban development in such regions should review the requirement for sub-surface drainage. We endorse this recommendation, but consider that extensive drainage infrastructure may not be required given the topography of the site.

4.3.2 Water and Sewerage

- Water and sewerage can be incorporated into the development by extensions to the existing Lower Murray Water systems. Development of this infrastructure to and within this region has been incorporated in the master planning of this authority. The topography of the site should promote good drainage for the sewer system and the requirement for “internal” pump stations should be limited.
- Lower Murray Water will need to be consulted early in the planning of the development for confirmation of the requirement for and location of a sewer pump station.

4.3.3 Power

- The provision of power infrastructure is not envisaged to raise any problems in this area.
- Powercor will need to be consulted to confirm the requirement for transformer reservations (nominally 6m x 4m).

4.3.4 Irrigation and Services

- The site is bounded by an irrigation channel and irrigation branches are to be located within the site. The requirement to retain these branches should be confirmed with the Sunraysia Rural Water Authority. The site also contains irrigation drains that may need to be retained with access under the protection of an easement.
- With the approval of the authority these potentially be retained and utilised as sub-surface drainage for the new development.

4.4 Landscape

- The Red Cliffs development area is a U shaped land parcel which is open to the north and surrounds a medium density residential development of about 60 houses. The residential area is moderately treed, while the development area is devoid of trees except for a citrus grove to the north-east. The balance of the land is planted to vine.

4.5 Traffic

- The proposed development area is generally bounded by low speed, low volume roadways that area unlikely to impose any special requirements

4.6 Strategic Context Plan

To graphically represent some of the opportunities and constraints associated with the development area, a Strategic Context Plan was prepared. This is presented in **Appendix B**.

4.7 Red Cliffs Development Plans

The "Red Cliffs Development Plan – Environmental Option" is presented in **Appendix C**.

This plan represents an environmentally sensitive approach to residential development which seeks to reduce the reliance on upgraded stormwater infrastructure. Best practice stormwater water management identifies the potential for stormwater to be utilised for the purposes of natural wetland systems or temporary and permanent water bodies. In turn, these features may contribute a unique and attractive feature when coupled with open space networks and bicycle paths.

This plan, together with the key design and development principles that apply to the development in Red Cliffs, are presented within.

4.7.1 Red Cliffs – Design and Development Principles

The following design and development principles were considered during the preparation of the Red Cliffs development plans and should be considered (amongst other matters) by:

- An applicant when preparing to subdivide and develop land; and
- Council when assessing an application to subdivide and develop land.

Principal 1 - Land Development

Principle 1.1 – Range of Lots Sizes

- Ability to subdivide land to a range of conventional urban lot sizes.

Principle 1.2 – Potential Land Use Conflict

- Recognise the relationship between potentially conflicting land uses including:
 - The surrounding rural land use activities to the immediate north, east and south of the development area.
 - Existing irrigation channels that traverse the development area and may pose an obstacle to pedestrian movement or require fencing.
 - Potentially noisy service infrastructure, particular the heritage listed (HO167) irrigation water pumps located to the east of the development area.

Principle 1.3 – Integration with Surrounds

- Encourage the protection and continuation of recognised features of the development area and surrounds including:
 - Recognised and listed heritage properties, particularly the heritage listed (HO167) irrigation water pump located to the east of the development area.
 - Existing drainage lines and topographical character.
 - Existing infrastructure and services, particular from conventional residential development to the west.
 - Provide for access to the open space network located immediately west of the development area.
 - Existing dwellings and structures identified through consultation to be retained in any future development.

Principal 2 - Road Network

Principal 2.1 – Safety and Efficiency

- Promote a safe and efficient local road network.

Principal 2.2 – Integration with Surrounds

- Creation of a collector and local street network to compliment the surrounding roads.

Principal 2.3 – Integration with Surrounds

- Extension of local streets networks through adjacent areas (where appropriate).

Principal 2.4 – Access to Major Roads

- Minimise and restrict the number of street access points to the surrounding road network.

Principal 3 - Infrastructure Provision

Principle 3.1 – Best practice services

- Promote best practice and environmentally sensitive solutions to the provision of infrastructure and services to the satisfaction of the relevant service authorities and Mildura Rural City Council.

Principle 3.2 – Co-location of Drainage Reserves and Open Space

- Encourage the provision of a drainage reserve / open space network designed to:
 - Compliment the existing and proposed drainage infrastructure

- Contribute a usable open space network for active and passive recreational activities.
- Contribute a marketable and visually attractive feature to the development area.
- Promote centralised access to open space within the development area.

Principle 3.3 – Infrastructure Retirement / Relocation

- Retire or relocate water supply or drainage infrastructure to the satisfaction of Lower Murray Water and/or Sunraysia Rural Water Authority.

Principle 4 – Staging of Development

Principle 4.1 – Co-ordination of Drainage Infrastructure

- Facilitate development in such a manner that is consistent with the provision of drainage infrastructure to the wider region.

Principle 4.2 – Cost Effective and Timely Development

- Stage development to enable cost effective and timely provision of infrastructure for development areas.

Principle 4.3 – Co-ordination Between Landowners

- Facilitate development of individual allotments with minimal reliance on adjoining landowners to provide access.

5. Implementation

Key issues associated with the implementation of the development plans are detailed below.

5.1 Staging

Development of the new residential areas should be staged to control the rate of release of residential land. This staging needs to take account of the relationships between separate new development precincts and within each precinct. Key considerations within the Mildura South Development Area are:

1. Land ownership;
2. Land owners' development intention;
3. Ability to gain Council approval; and
4. Ability to service land (ie development contributions).

Considerable work is still required before the land can be developed. This includes:

- feature surveys;
- subdivision approvals through Council;
- approval from service authorities and VicRoads for various components of the development;
- undertake detailed engineering design.

Detailed below is an account of some of these factors and their role in the implementation of Council's adopted ("preferred") development plans.

5.2 Ownership

Fragmented land ownership patterns have the potential to complicate the implementation of a development plan.

Co-operation and co-ordination between landowners will be required to ensure that construction within development area proceeds in an orderly and cost effective manner.

The Red Cliff development area is characterised by multiple land ownership. An attempt to accommodate the future development intentions of individual landowners has been made in the preparation of these plans. Acknowledging that individual circumstances may change over time, the Mildura Planning Scheme and the provisions of the Development Plan Overlay (and associated schedules) have been drafted to allow changes to the plans that are generally consistent with Council's adopted development plans and their associated design and development principles.

During the preparation of the development plans, consideration was given to facilitating development of individual allotments with minimal reliance on adjoining landowners to provide access. Despite this, in some cases a greater level of landowner / developer co-operation and co-ordination will be required to implement the plans. It is recommended that this approach be strongly supported by Mildura Rural City Council through the planning approval process.

5.3 Development Contribution Plan

A Development Contribution Plan provides a single mechanism through which Council and other service authorities can co-ordinate the collection of costs associated with undertaking buildings and works to develop and service land.

An example of the type of costs that have been levied through development contributions in the past by other Council's include:

- Roads
- Streetscape and environmental works
- Active Open Space
- Drainage
- Traffic management works
- Parks
- Community Activity Centres

Under the Victorian Planning Provision, Council may apply a Development Contribution Plan Overlay to land to formalise the collection of development contributions. No overlays currently apply to any of the development areas subject to this project.

An alternative mechanism often used by Council to co-ordinate collection of development contributions is available under Section 173 of the Planning and Environment Act 1987. This mechanism enables Council to negotiate an agreement with a landowner to set out conditions or restrictions on the use or development of the land, or to achieve other planning objectives in relation to the land. A s.173 agreement is a legal contract and can be registered over the title of the land, effectively binding the current and future owners and occupiers of the land. The existence of a s.173 agreement is also notifiable under the Sale of Land Act.

Whether development contributions are gathered via the Development Contributions Overlay or a Section 173 Agreement mechanism, it is strongly recommended that Council use these mechanisms to equitably collect and apply funds required for development infrastructure in the growth areas. The costs associated with the development should be presented in a suitably formatted and worded document to be incorporated into a Development Contribution Plan Overlay or a Section 173 Agreement.

5.4 Future Planning Scheme Review

Mildura Rural City Council is about to conduct a three-year review of the Mildura Planning Scheme.

It is envisaged that this review will give particular consideration to:

1. Municipal Strategic Statement (Clause 21)
2. Local Planning Policies (Clause 22)
3. Schedules to Zones
4. Schedules to Overlays

Without pre-empting the issues and outcomes of this review, it is envisaged that the planning for residential development areas will be reviewed at this time and may impact on the implementation of the development plan presented within.

5.5 Approval processes

Planning approvals to subdivide land generally in accordance with the development plans will enable normal advertising procedures to be exempted under the provisions of the Development Plan Overlay.

In all cases, Council approval will be required to subdivide land and all provisions of the Mildura Planning Scheme must be complied with.

6. Draft Development Plan Schedules

The Development Plan Overlay forms part of the Victorian Planning Provisions (VPP's) which provide a suite of planning controls that can be used by Council and Planning Authorities to control and regulate land use and development.

The purpose of the Development Plan Overlay is:

- To implement the State Planning Policy Framework and the Local Planning Policy Framework, including the Municipal Strategic Statement and local planning policies;
- To identify areas which require the form and conditions of future use and development to be shown on a development plan before planning permit can be granted to use or develop the land.
- To exempt an application from notice and review if it is generally in accordance with a development plan.

A development plan may consist of plans or other documents and may, with the agreement of the responsible authority, be prepared and implemented in stages.

The development plan must describe:

- The land to which the plan applies.
- The proposed use and development of each part of the land.
- Any other requirements specified for the plan in a schedule to the overlay.

Draft DPO schedules for each of the development plan areas are proposed to highlight other requirements that could be incorporated in the schedule.

The purpose of these schedules are:

1. To assist in the preparation of a formal planning scheme amendment;
2. To compliment the controls of the Development Plan Overlay that apply to the majority of area covered by this project by reflecting local conditions and requirements; and
3. To guide applicants and Council in the preparation and assessment of development applications.

Depending on the Development Plan to be adopted by Council, the associated schedule may be modified (prior to being formally adopted) to accommodate issues particular to the adopted plan.

SCHEDULE 6 TO THE DEVELOPMENT PLAN OVERLAY

Shown on the planning scheme map as **DP06**

RED CLIFFS - FUTURE RESIDENTIAL AREA

1.0 Conditions and requirements for permits

Any subdivision must be generally consistent with the road layout and lot size distribution indicated in the development plan.

Any permit granted will require the provision of reticulated water, sewerage and electricity and sealed roads.

2.0 Requirements for development plan

The development plan should be generally consistent with the Red Cliffs Development Plan (Environmental Option), prepared by Connell Wagner, Reference s01004B0-06, dated 15 November 2002 and show:

- The location, dimensions and areas of all lots.
- Existing and proposed road network.
- The location of proposed open space including open space linkages.
- The location of proposed landscaping.
- The location of major infrastructure services and drainage lines.
- An overall scheme for landscape planting of vegetation.
- Staging and anticipated timing of development.

3.0 Decision guidelines

Before deciding on any application, the Responsible Authority must consider:

- The approved development plan.
- Whether the proposal will contribute to the integrated development of the area.
- Access to the road network to be to the satisfaction of, and at no cost to, the responsible authority or VicRoads.
- The Design and Development Principles considered during the preparation of the Red Cliffs Development Plans as detailed below:

Principle 1 - Land Development

Principle 1.1 – Range of Lots Sizes

- Ability to subdivide land for a range of conventional urban lot sizes.

Principle 1.2 – Potential Land Use Conflict

- Recognise the relationship between potentially conflicting land uses including:
 - The surrounding rural land use activities to the immediate north, east and south of the development area.

- Existing irrigation channels that traverse the development area and may pose an obstacle to pedestrian movement or require fencing.
- Potentially noisy service infrastructure, particularly the heritage listed (HO167) irrigation water pumps located to the east of the development area.

Principle 1.3 – Integration with Surrounds

- Encourage the protection and continuation of recognised features of the development area and surrounds including:
 - Recognised and listed heritage properties, particularly the heritage listed (HO167) irrigation water pump located to the east of the development area.
 - Existing drainage lines and topographical character.
 - Existing infrastructure and services, particularly from conventional residential development to the west.
 - Provide for access to the open space network located immediately west of the development area.
 - Existing dwellings and properties identified through consultation for retention.

Principle 2 - Road Network

Principle 2.1 – Safety and Efficiency

- Promote a safe and efficient local road network.

Principle 2.2 – Integration with Surrounds

- Creation of a collector and local street network to compliment the surrounding roads.

Principle 2.3 – Integration with Surrounds

- Extension of local street networks through adjacent areas (where appropriate).

Principle 2.4 – Access to Major Roads

- Minimise and restrict the number of street access points to the surrounding road network.

Principle 3 - Infrastructure Provision

Principle 3.1 – Best practice services

- Promote best practice and environmentally sustainable design solutions to the provision of infrastructure and services to the satisfaction of the relevant service authorities and Mildura Rural City Council.

Principle 3.2 – Co-location of Drainage Reserves and Open Space

- Encourage the provision of a drainage reserve / open space network designed to:
 - Compliment the existing and proposed drainage infrastructure.

-
- Contribute a useable open space network for active and passive recreational activities.
 - Contribute a marketable and visually attractive feature to the development area.
 - Promote centralised access to open space within the development area.

Principle 3.3 – Infrastructure Retirement / Relocation

- Retire or relocate water supply or drainage infrastructure to the satisfaction of Lower Murray Water and/or the Sunraysia Rural Water Authority.

Principle 4 – Staging of Development

Principle 4.1 – Co-ordination of Drainage Infrastructure

- Facilitate development in such a manner that is consistent with the provision of drainage infrastructure to the wider region.

Principle 4.2 – Cost Effective and Timely Development

- Stage development in such a manner to accommodate cost effective and timely development of infrastructure for development areas.

Principle 4.3 – Co-ordination Between Landowners

- Facilitate development of individual allotments with minimal reliance on adjoining landowners to provide access.

Appendix A

Aerial Photograph



Appendix B

Strategic Context Plan

Red Cliffs

Strategic Context Plan



Rural

Rural

*HO167

*HO160

PPR1

Open space linkages

Existing

Residential

Existing Residential

PUZZ

PUZ1

RIZ

RIZ

RIZ

RIZ

PUZ1

LDR2

RIZ

PUZ6

- Red Cliffs
- Precinct is bound by Indi Ave, Cocklin Ave and Guava Street. Existing residential layouts have collector roads, with small access streets. These long streets are potential speed-runs.
- North: Isolated residential estate with regular lot shapes fronting Tambo Road. Lot sizes range from 1500m² - 1800m². Further north, larger rural lots.
- South: Directly south of precinct are two large lots, but further south and south-east along Kurrajong and Nursery Ridge Street, established residential estate with lot sizes ranging from 700m² - 900m². Nursery Ridge lots orientate east-west.
- East: Large lot rural land
- West: Established residential lots with mixed orientation and regular in size of approx. 800m²

Indicative, not to scale

This plan has been prepared for identifying the features of the development area

Connell Wagner

Appendix C

Development Plan

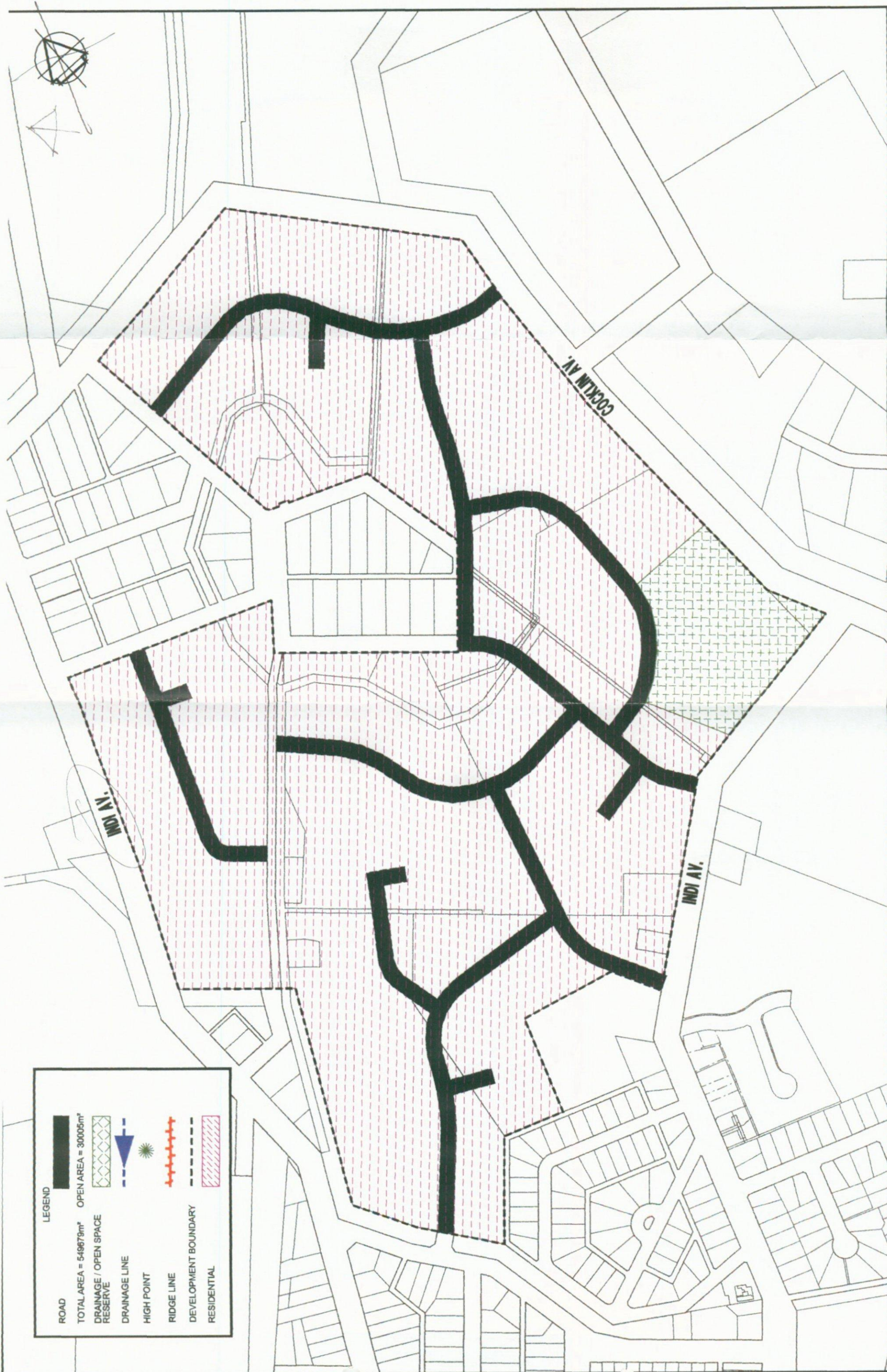

LEGEND

ROAD	TOTAL AREA = 549679m ²	OPEN AREA = 30005m ²
DRAINAGE / OPEN SPACE RESERVE	DRAINAGE LINE	HIGH POINT
RIDGE LINE	DEVELOPMENT BOUNDARY	RESIDENTIAL

Connell Wagner Connell Wagner Pty Ltd ABN 54 005 139 873 60 Albert Road (PO Box 321) South Melbourne Victoria 3205 Australia Telephone: +61 3 9697 8333 Facsimile: +61 3 9697 8444 Email: cwnell@connellwagner.com.au	MILDURA RURAL CITY COUNCIL	DEVELOPMENT PLANS FOR DISCUSSION PURPOSES ONLY	RED CLIFFS ENVIRONMENTAL OPTION	Date 15/11/2002
				Scale 1:4000 at A3
				Job No S010.04
				Dwg S01004B0-06